



 **moviroll**  
 **movicart**

ROLL PUSHERS & CART MOVERS



# moviroll movicart

More productivity, higher safety level

Moviroll roll pushers and Movicart cart movers improve the productivity and increase the safety level as they allow the operator to effortlessly and safely maneuver both large and small cylindrical loads as well as carts. Moviroll and Movicart reduce risks for the operator according to the Technical Standards ISO 11228 “Ergonomics Manual handling”.

They are ideal to move paper and tissue rolls, wire and cable reels and drums as well as vehicles and carts, but they are also used to move loads in several other industrial applications.

A wide range of pneumatically and battery operated models plus a variety of optionals and accessories are available, all of them designed, manufactured and assembled on site at Renova. For this reason we are able to quickly work on customized projects at competitive prices.

Send us your application requirements and we will work with you to find the model that suits your needs.

Click on the “play” icons in this catalog and see demonstration videos!





A person wearing a grey long-sleeved shirt, dark cargo pants with orange accents, and white sneakers is operating a black battery-powered pallet jack. The jack is moving a large, light-colored roll of material. The background is a simple, light-colored wall and floor. The text "BATTERY DRIVEN MODELS" is overlaid on the left side of the image.

# BATTERY DRIVEN MODELS



# LITHIUM BATTERY

We have always equipped our battery driven models with the highest quality lithium batteries. By this, we have been able to provide the highest performance systems with the longest running time respecting the environment and safeguarding the health of the operator. We offer different designs and voltage according to the Moviroll or Movicart model.



## LONG LASTING CHARGE

60-120 loads handling with only one battery charge (3-5 working shifts)

## RAPID BATTERY RECHARGE

max 4 hours required for full recharge

## LONG LIFE BATTERY

about 500 recharges

## 2 YEAR BATTERY WARRANTY



Battery charger provided

## PLUG & PLAY

Quick battery changes in less than 10 seconds.

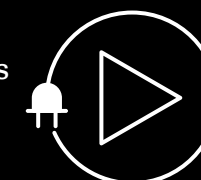

## ECO-FRIENDLY

Completely free of any polluting substance, safe for the operator and the environment

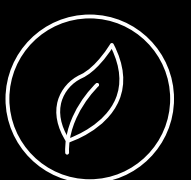

# BATTERY ROLL PUSHERS

Battery roll pushers offer the advantage of free movement without the constraints of the pneumatic connections or electrical cables.

They are equipped with 24 V DC IP 44 or 48 V DC IP 44 brushless motor powered by high performance and plug&play 24 V or 48 V lithium battery.

## VARIABLE SPEED

to suit any operator needs



## FORWARD AND REVERS GEAR

two separated and intuitive buttons shielded from dirt, dust and water

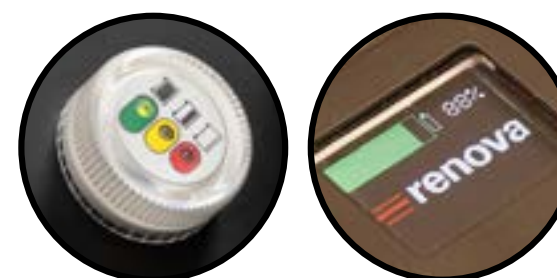

## CHARGER STATUS INDICATOR

easily see when the battery needs to be recharged



## ON/OFF SWITCH

it preserves the battery charge without the need of removing the battery from the system



## CUT FRAMES

for an easy removal of the roller and roller bearings

## OVERSIZED WHEELS

to easily overcome any obstacles along the way



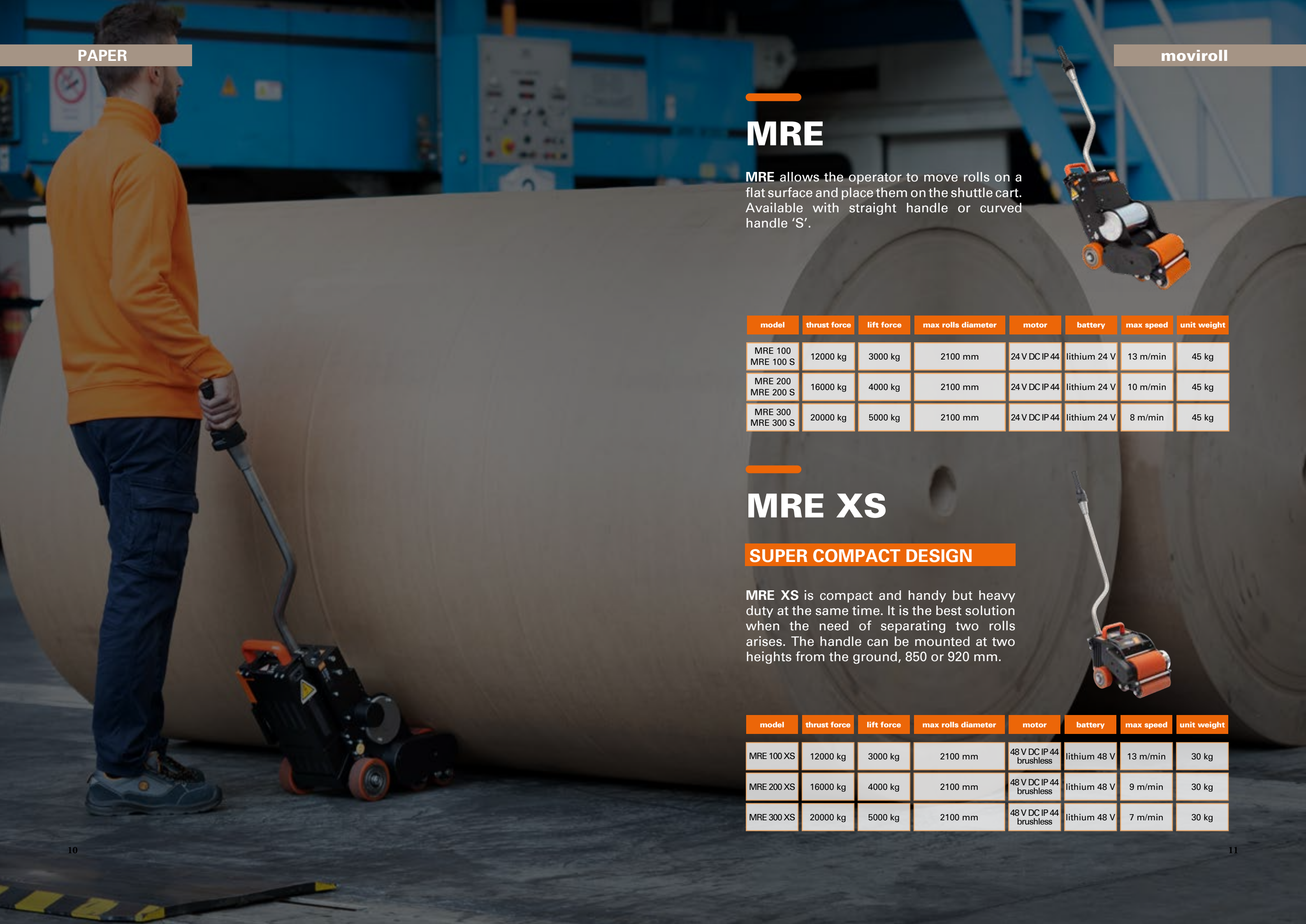

# MRE

MRE allows the operator to move rolls on a flat surface and place them on the shuttle cart. Available with straight handle or curved handle 'S'.



| model                | thrust force | lift force | max rolls diameter | motor         | battery      | max speed | unit weight |
|----------------------|--------------|------------|--------------------|---------------|--------------|-----------|-------------|
| MRE 100<br>MRE 100 S | 12000 kg     | 3000 kg    | 2100 mm            | 24 V DC IP 44 | lithium 24 V | 13 m/min  | 45 kg       |
| MRE 200<br>MRE 200 S | 16000 kg     | 4000 kg    | 2100 mm            | 24 V DC IP 44 | lithium 24 V | 10 m/min  | 45 kg       |
| MRE 300<br>MRE 300 S | 20000 kg     | 5000 kg    | 2100 mm            | 24 V DC IP 44 | lithium 24 V | 8 m/min   | 45 kg       |

# MRE XS

## SUPER COMPACT DESIGN

MRE XS is compact and handy but heavy duty at the same time. It is the best solution when the need of separating two rolls arises. The handle can be mounted at two heights from the ground, 850 or 920 mm.



| model      | thrust force | lift force | max rolls diameter | motor                      | battery      | max speed | unit weight |
|------------|--------------|------------|--------------------|----------------------------|--------------|-----------|-------------|
| MRE 100 XS | 12000 kg     | 3000 kg    | 2100 mm            | 48 V DC IP 44<br>brushless | lithium 48 V | 13 m/min  | 30 kg       |
| MRE 200 XS | 16000 kg     | 4000 kg    | 2100 mm            | 48 V DC IP 44<br>brushless | lithium 48 V | 9 m/min   | 30 kg       |
| MRE 300 XS | 20000 kg     | 5000 kg    | 2100 mm            | 48 V DC IP 44<br>brushless | lithium 48 V | 7 m/min   | 30 kg       |



# MRE LPT

MRE LPT is equipped with an OVERSIZED ROLLER especially designed to handle soft material rolls and to prevent roll damages.



| model       | thrust force | lift force | max rolls diameter | motor         | battery      | max speed | unit weight |
|-------------|--------------|------------|--------------------|---------------|--------------|-----------|-------------|
| MRE 100 LPT | 12000 kg     | 3000 kg    | 4500 mm            | 24 V DC IP 44 | lithium 24 V | 13 m/min  | 36 kg       |
| MRE 200 LPT | 16000 kg     | 4000 kg    | 4500 mm            | 24 V DC IP 44 | lithium 24 V | 9,3 m/min | 36 kg       |
| MRE 300 LPT | 20000 kg     | 5000 kg    | 4500 mm            | 24 V DC IP 44 | lithium 24 V | 7,5 m/min | 36 kg       |

# MRE XS LPT

## SUPER COMPACT DESIGN

MRE XS LPT is compact and handy but heavy duty at the same time. The handle can be mounted at two heights from the ground, 850 or 920 mm. It is equipped with an OVERSIZED ROLLER to handle soft material rolls and to prevent roll damages.



| model          | thrust force | lift force | max rolls diameter | motor                   | battery      | max speed | unit weight |
|----------------|--------------|------------|--------------------|-------------------------|--------------|-----------|-------------|
| MRE 100 XS LPT | 12000 kg     | 3000 kg    | 2100 mm            | 48 V DC IP 44 brushless | lithium 48 V | 13 m/min  | 30 kg       |
| MRE 200 XS LPT | 16000 kg     | 4000 kg    | 2100 mm            | 48 V DC IP 44 brushless | lithium 48 V | 9 m/min   | 30 kg       |
| MRE 300 XS LPT | 20000 kg     | 5000 kg    | 2100 mm            | 48 V DC IP 44 brushless | lithium 48 V | 7 m/min   | 30 kg       |



# MRE L

MRE L is equipped with a TILTING HANDLE: when the working space is limited, the operator can work alongside the load needing only to turn the handle and “pull” the load instead of thrusting it.

| model     | thrust force | max rolls diameter | motor         | battery      | max speed | unit weight |
|-----------|--------------|--------------------|---------------|--------------|-----------|-------------|
| MRE 100 L | 15000 kg     | 4500 mm            | 24 V DC IP 44 | lithium 24 V | 5 m/min   | 36 kg       |
| MRE 200 L | 20000 kg     | 4500 mm            | 24 V DC IP 44 | lithium 24 V | 4 m/min   | 36 kg       |
| MRE 300 L | 30000 kg     | 4500 mm            | 24 V DC IP 44 | lithium 24 V | 2,5 m/min | 36 kg       |
| MRE 500 L | 50000 kg     | 6000 mm            | 24 V DC IP 44 | lithium 24 V | 3,5 m/min | 50 kg       |

# MRE XS L

## SUPER COMPACT DESIGN

MRE XS L is compact and handy but heavy duty at the same time. The handle can be mounted at two heights from the ground, 850 or 920 mm.

| model        | thrust force | max rolls diameter | motor                   | battery      | max speed | unit weight |
|--------------|--------------|--------------------|-------------------------|--------------|-----------|-------------|
| MRE 100 XS L | 30000 kg     | 2900 mm            | 48 V DC IP 44 brushless | lithium 48 V | 8 m/min   | 30 kg       |
| MRE 200 XS L | 35000 kg     | 2900 mm            | 48 V DC IP 44 brushless | lithium 48 V | 6 m/min   | 30 kg       |
| MRE 300 XS L | 40000 kg     | 2900 mm            | 48 V DC IP 44 brushless | lithium 48 V | 4 m/min   | 30 kg       |



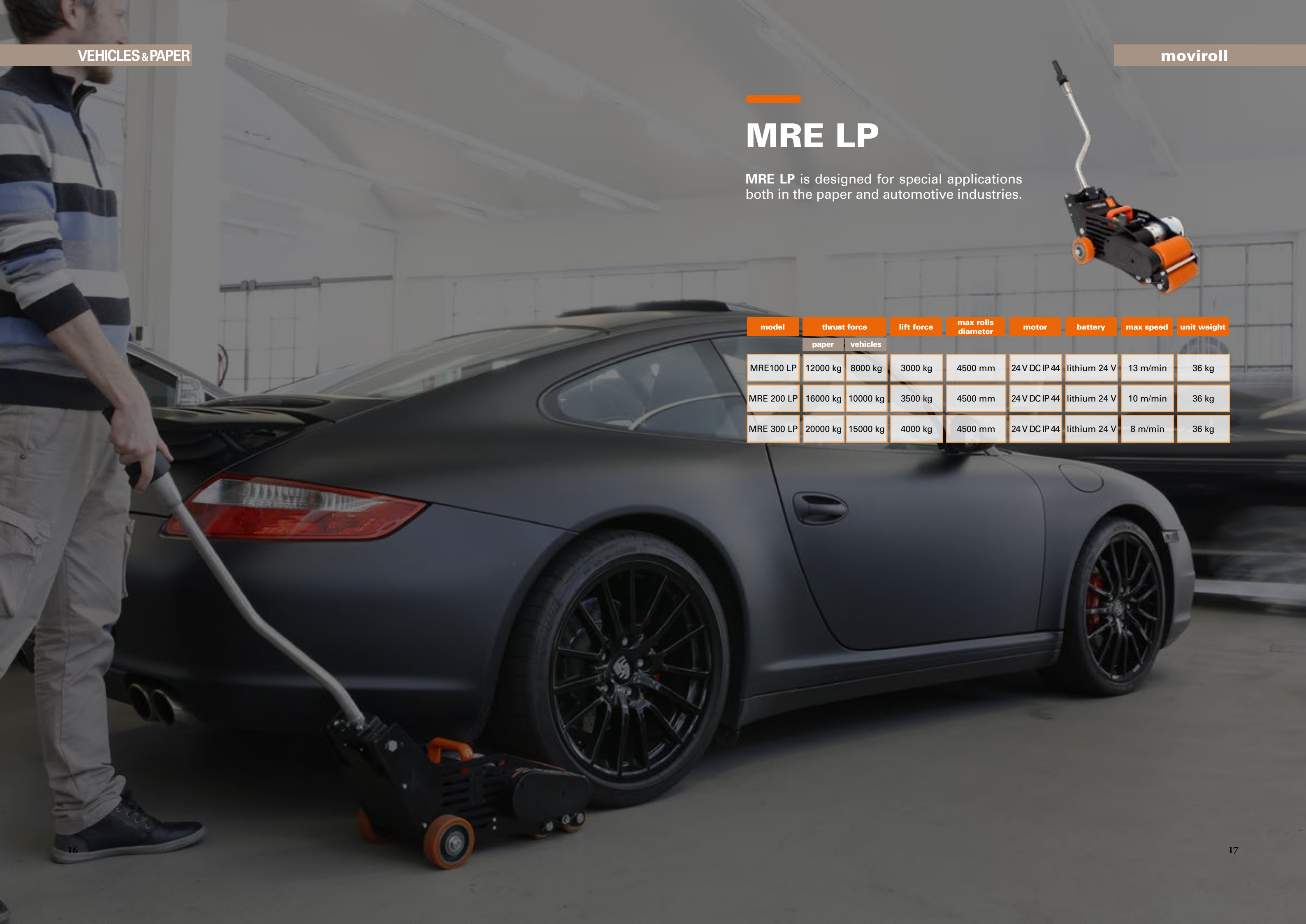

# MRE LP

MRE LP is designed for special applications both in the paper and automotive industries.



| model      | thrust force |          | lift force | max rolls diameter | motor         | battery      | max speed | unit weight |
|------------|--------------|----------|------------|--------------------|---------------|--------------|-----------|-------------|
|            | paper        | vehicles |            |                    |               |              |           |             |
| MRE100 LP  | 12000 kg     | 8000 kg  | 3000 kg    | 4500 mm            | 24 V DC IP 44 | lithium 24 V | 13 m/min  | 36 kg       |
| MRE 200 LP | 16000 kg     | 10000 kg | 3500 kg    | 4500 mm            | 24 V DC IP 44 | lithium 24 V | 10 m/min  | 36 kg       |
| MRE 300 LP | 20000 kg     | 15000 kg | 4000 kg    | 4500 mm            | 24 V DC IP 44 | lithium 24 V | 8 m/min   | 36 kg       |



# BATTERY CART MOVERS

Movicart is a compact and handy system designed to safely push or pull your existing carts (both on wheels or rails) without additional effort from the operator, quickly engaging up to 5000 kg thrust force.

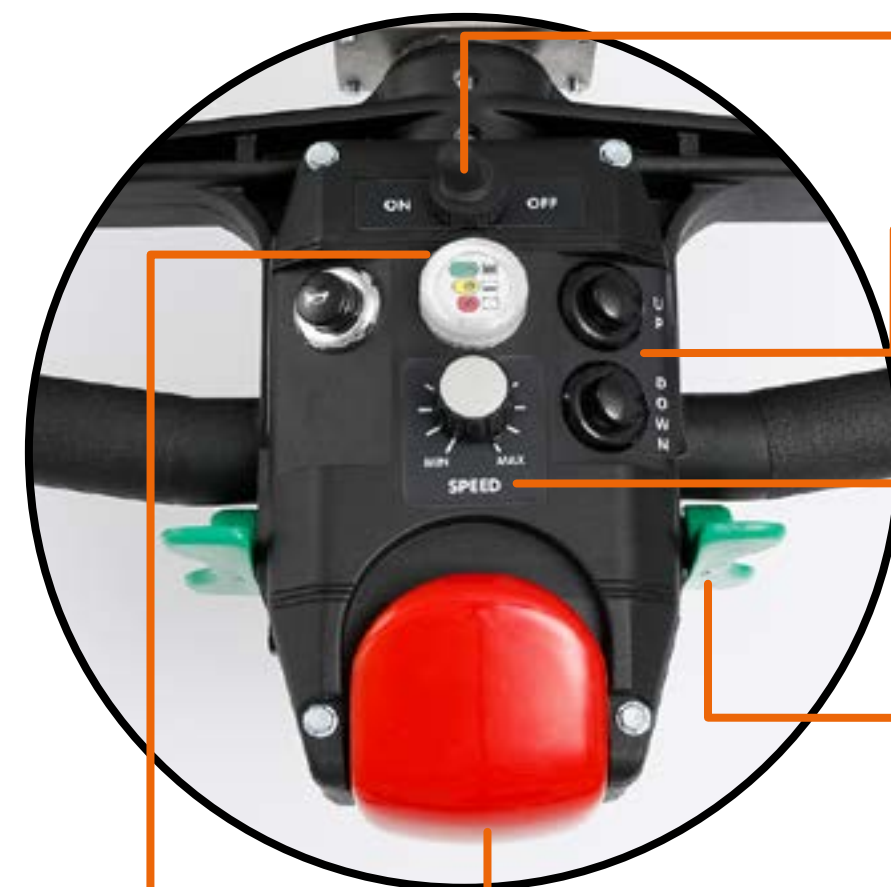

## ON/OFF SWITCH

to preserve the battery charge

## UP/DOWN BUTTONS

cart gripper raising and lowering controls

## MAX SPEED ADJUSTMENT

to suit any operator needs

## FORWARD AND REVERSE GEAR

## EMERGENCY STOP BELLY BUTTON

as a safety precaution, Movicart will reverse direction from backing up to forward if the button hits the operator

## BATTERY STATUS LEDS

easily see when the battery needs to be recharged

## LIFTER

place the movicart under the cart and then smoothly hook it at the right height

## OMNIDIRECTIONAL WHEELS

effortlessly change cart direction



MCE

**MOVICART** is designed to effortlessly move any cart, on wheels or on rails. Thanks to its various configurations, it can move carts of different sizes, heights and weights.

| model     | thrust force | lift force | motor                   | battery      | max speed | unit weight |
|-----------|--------------|------------|-------------------------|--------------|-----------|-------------|
| MCE 400   | 400 kg       | 25 kg      | 24 V DC IP 44 brushless | lithium 24 V | 30 m/min  | 38 kg       |
| MCE 400 E | 5000 kg      | 150 kg     | 24 V DC IP 44 brushless | lithium 24 V | 30 m/min  | 38 kg       |



# CONFIGURATIONS

## CART GRIPPERS

MCEP0102

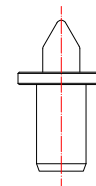

A

HOOK

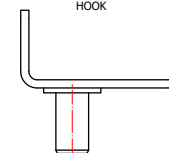

B

RUBBER PLATE

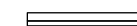

C

KIT

CART FRAME

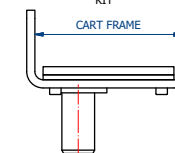

| cart frame (mm) | A        | B        | C        |
|-----------------|----------|----------|----------|
| 30 - 50         | MCEP0068 | MCEP0077 | MCEP0087 |
| 50 - 80         | MCEP0070 | MCEP0080 | MCEP0088 |
| 80 - 120        | MCEP0072 | MCEP0083 | MCEP0089 |
| 120 - 150       | MCEP0074 | MCEP0086 | MCEP0090 |

## BUSHINGS

MCEP0016

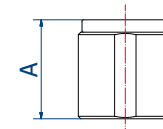

MCEP0065  
Only for  
MCE400

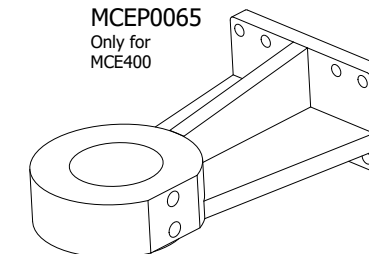

| A (mm) | 40       | 75       | 110      | 145      | 180      | 215      |
|--------|----------|----------|----------|----------|----------|----------|
| code   | MCEP0096 | MCEP0097 | MCEP0098 | MCEP0099 | MCEP0100 | MCEP0101 |

## HANDLE EXTENSION

Handle extension available to space out from protruding loads.

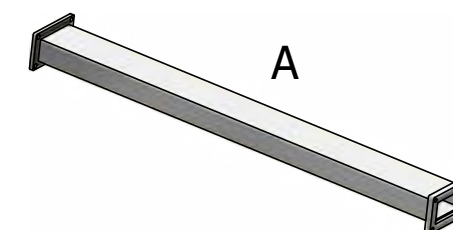

A

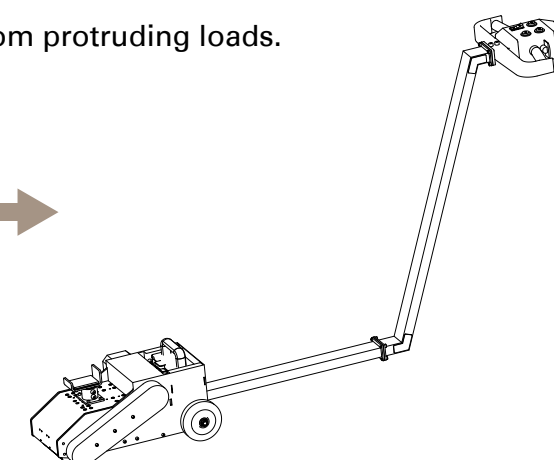

| A (mm) | 610      |
|--------|----------|
| code   | MCEP0104 |



A large wooden cable reel is the central focus, with the brand name 'Prysmian Group' visible on its side. In the foreground, a coiled orange pneumatic hose is connected to a small, black, wheeled pneumatic tool. The background shows a factory floor with several other similar cable reels stacked on pallets. The image is overlaid with a semi-transparent dark grey geometric shape on the left and bottom right.

# PNEUMATIC DRIVEN MODELS



# PNEUMATIC ROLL PUSHERS

Pneumatic roll pushers use the power of a high quality pneumatic gear motor powered by pressurized and lubricated air at 6 bar. Pneumatic models are designed to offer the highest performances and to keep them unchanged over time.

All pneumatic models are available with straight handle or curved handle "S".

## SAFE ACTIVATION OF ROLLERS

applied only at the load

## POWERFUL MOTOR

## STURDY DESIGN

compact, handy and heavy duty



MR  
MR H

MR

MR is the standard pneumatic model for any type of paper reel. A proper maintenance of the engine with lubricating oil guarantees its correct conservation and performances over time.

MR H

Twin to the standard version, MR H engine doesn't need lubricating oil. This means sustaining the same performances with inferior consumptions and maintenance costs.



| model               | thrust force |          | lift force | max rolls diameter | max speed | air pressure | air consumption | unit weight |
|---------------------|--------------|----------|------------|--------------------|-----------|--------------|-----------------|-------------|
|                     | paper        | vehicles |            |                    |           |              |                 |             |
| MR100<br>MR100 S    | 10000 kg     | 15000 kg | 2500 kg    | 2600 mm            | 24 m/min  | 6-7 bar      | 28 l/sec        | 24 kg       |
| MR200<br>MR200 S    | 20000 kg     | 20000 kg | 5000 kg    | 2600 mm            | 20 m/min  | 6-7 bar      | 40 l/sec        | 24 kg       |
| MR100 H<br>MR100 SH | 10000 kg     | 15000 kg | 2500 kg    | 2600 mm            | 20 m/min  | 6-7 bar      | 22 l/sec        | 20 kg       |
| MR200 H<br>MR200 SH | 20000 kg     | 20000 kg | 5000 kg    | 2600 mm            | 18 m/min  | 6-7 bar      | 34 l/sec        | 21,5 kg     |



MR L



**MR L** is dedicated to the wire & cable industry. The engine has the same power as MR, but it's been designed with reduced and controlled speed to ensure the operator safety in handling even the largest and heaviest drums.

| model    | thrust force | max rolls diameter | max speed | air pressure | air consumption | unit weight |
|----------|--------------|--------------------|-----------|--------------|-----------------|-------------|
| MR100 L  | 20000 kg     | 2600 mm            | 15 m/min  | 6-7 bar      | 28 l/sec        | 24 kg       |
| MR100 SL | 20000 kg     | 3100 mm            | 15 m/min  | 6-7 bar      | 28 l/sec        | 24 kg       |
| MR200 L  | 30000 kg     | 2600 mm            | 13 m/min  | 6-7 bar      | 40 l/sec        | 24 kg       |
| MR200 SL | 30000 kg     | 3100 mm            | 13 m/min  | 6-7 bar      | 40 l/sec        | 24 kg       |





The background image shows a large, orange-painted industrial wheel, possibly a part of a ship's hull or a large storage tank. A black metal support stand with two orange wheels is positioned against the wheel. A black rectangular plate with the 'renova' logo is placed on the ground next to the stand. The text 'OPTIONALS AND ACCESSORIES' is overlaid in white, bold, sans-serif font. A small orange horizontal line is positioned above the text.

# OPTIONALS AND ACCESSORIES





## REEL TURNER

Ideal for rotating or reorientating flanged reels (as wire and cable reels) up to 8000 kg.

CODE: RTS8000

## SAFETY STOP WEDGE

Used as a safety precaution to prevent large rolls from rolling beyond their intended travel.

CODE: WSS8000



# ROTATING PLATE

Allows the operator to safely rotate 360° cylindrical loads without any effort.

| model   | load capacity | rotation | unit weight | unit dimensions |
|---------|---------------|----------|-------------|-----------------|
| PRT7000 | 7000 kg       | 360°     | 46 kg       | 700 x 680 mm    |
| PRT2000 | 2000 kg       | 360°     | 35 kg       | 400 x 380 mm    |

# PLATE

Designed to push reels on shuttle cart into the rollstand area. It can be easily added to the Moviroll MRE only.



# HANDLES

A wide range of different handles are available for all battery driven roll pushers.

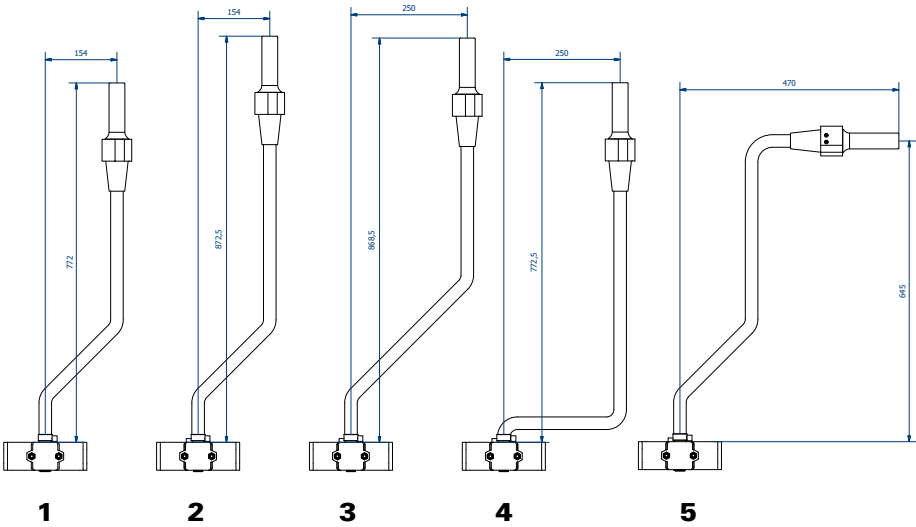

# AIR SUPPLY KIT

Only for pneumatic roll pushers.  
It is inclusive of:

- spiral pipe
- lubricator filter
- pipe fitting



CODE: MVRK001





# PRODUCT SELECTION



# QUESTIONNAIRE

 Please fill out the questionnaire, take a picture and send it via email to [info@renova-srl.com](mailto:info@renova-srl.com)

CUSTOMER

complete name  
position  
company  
plant  
country  
tel  
email

| model  | quantity |
|--|----------|
| <input type="checkbox"/> movirol MRE<br>battery roll pusher  |          |
| <input type="checkbox"/> movirol MR<br>pneumatic roll pusher |          |

PLEASE PROVIDE THE FOLLOWING INFORMATION

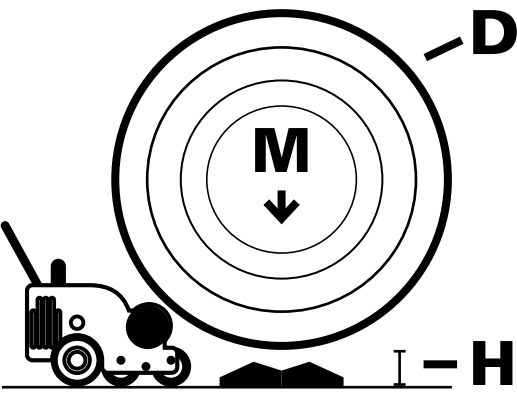

|      |                     |      |    |  |  |
|------|---------------------|------|----|--|--|
| M    | roll weight         |      |    |  |  |
| min. | kg                  | max. | kg |  |  |
| D    | roll diameter       |      |    |  |  |
| min. | mm                  | max. | mm |  |  |
| H    | shuttle cart height |      |    |  |  |
|      | mm                  |      |    |  |  |

|                                       |
|---------------------------------------|
| roll material                         |
| <input type="checkbox"/> paper        |
| <input type="checkbox"/> tissue       |
| <input type="checkbox"/> wire & cable |
| <input type="checkbox"/> other        |
| please specify                        |

|  |
|--|
| voltage for battery charger                  |
| <input type="checkbox"/> 110 V (3-pin plug)  |
| <input type="checkbox"/> 220 V (schuko plug) |

# QUESTIONNAIRE

 Please fill out the questionnaire, take a picture and send it via email to [info@renova-srl.com](mailto:info@renova-srl.com)

CUSTOMER

complete name  
position  
company  
plant  
country  
tel  
email

| model   | quantity |
|---|----------|
| <input type="checkbox"/> movicart MCE 400<br>battery cart mover   |          |
| <input type="checkbox"/> movicart MCE 400 E<br>battery cart mover |          |

PLEASE PROVIDE THE FOLLOWING INFORMATION

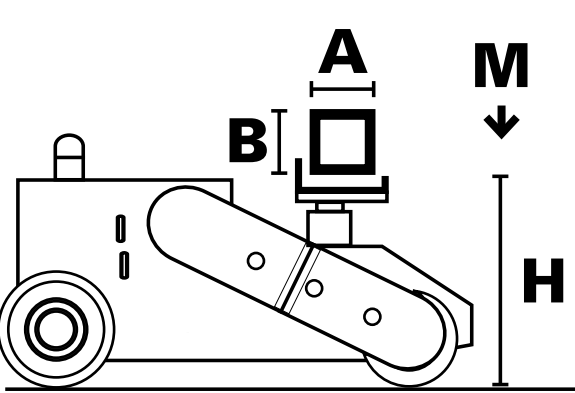

|      |                              |      |    |  |  |
|------|------------------------------|------|----|--|--|
| A    | cart frame                   |      |    |  |  |
| B    | cart frame                   |      |    |  |  |
|      | mm                           |      | mm |  |  |
| H    | cart frame height from floor |      |    |  |  |
| min. | mm                           |      |    |  |  |
| M    | cart weight                  |      |    |  |  |
| min. | kg                           | max. | kg |  |  |

|  |
|--|
| binding condition for a proper use of movicart                                   |
| <input type="checkbox"/> absence of step on the floor                            |
| <input type="checkbox"/> cart equipped with 2 fixed wheels and 2 pivoting wheels |

|  |
|--|
| voltage for battery charger                  |
| <input type="checkbox"/> 110 V (3-pin plug)  |
| <input type="checkbox"/> 220 V (schuko plug) |





**MADE IN ITALY**  
Our products are 100% designed and made in Italy

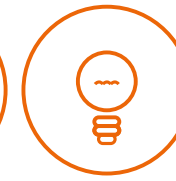

**SUPPORT**  
Our staff is always available to answer your questions, also in the after-sales phase

**INNOVATION**  
We provide solutions that increase productivity and safety levels while reducing maintenance costs and procedures



**CUSTOM PROJECTS**  
Projects large or small, we work with you to provide the solution that fits

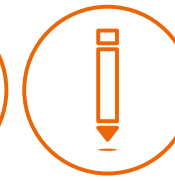

**QUALITY**  
All Renova's products are managed by TUV ISO 9001



**SUSTAINABILITY**  
Sustainable products, sustainable company. Renova has joined Erion



**renova**  
WE NEVER LOSE CONTROL



